

Wiring Drawing

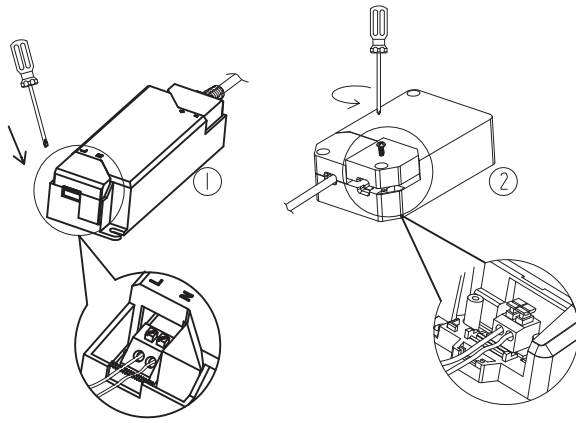

1. Insert the AC line "L"、 "N" terminal, use screws to fix protective cover.

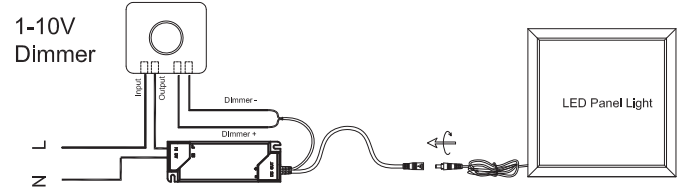
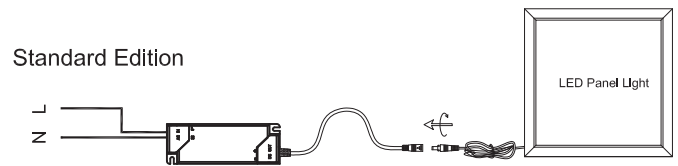

Installation Drawing

Schematic diagram for recessed installation

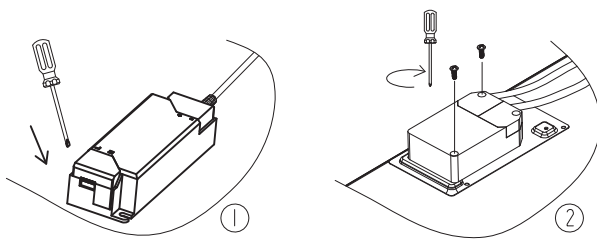

1. Connect the power input wire, then fixed power supply.

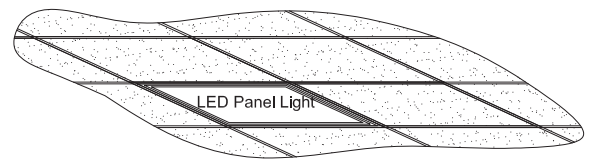

3. Check LED panel is mounted properly and securely.

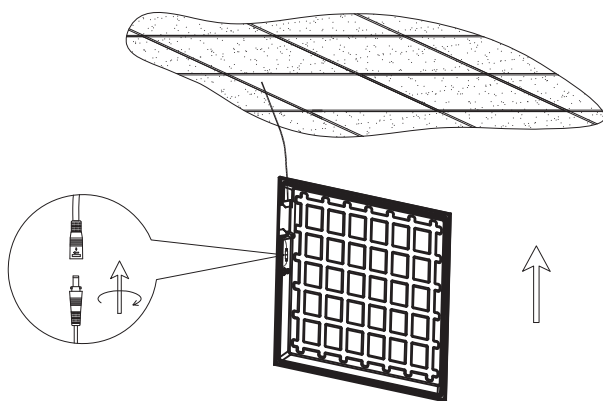

2. Connect the power line, then put LED panel on the ceiling screens.